

Installation Guide

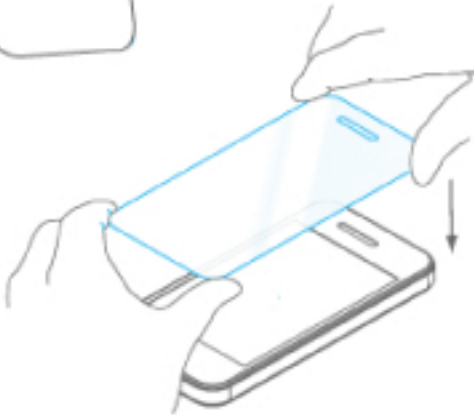

1. Before beginning, make sure to wash your hands thoroughly wipe your screen with the provided alcohol swab and microfiber cloth.



3. Carefully align the GLAS.t and the cutouts to the screen and slowly begin the application process.



GLAS.t

2. Peel the protective layer off the adhesive side. The layer is attached to the "Back" tab.



4. Press the center of the GLAS.t lightly. (only a minimum amount of pressure is necessary) The adhesive will begin to spread over the screen smoothly.

5. If air bubbles get trapped under the GLAS.t, use the squeegee to remove them, beginning from the center.

6. Smaller bubbles should disappear within 1 -2 days. (Bubbles due to dust will not disappear)

